

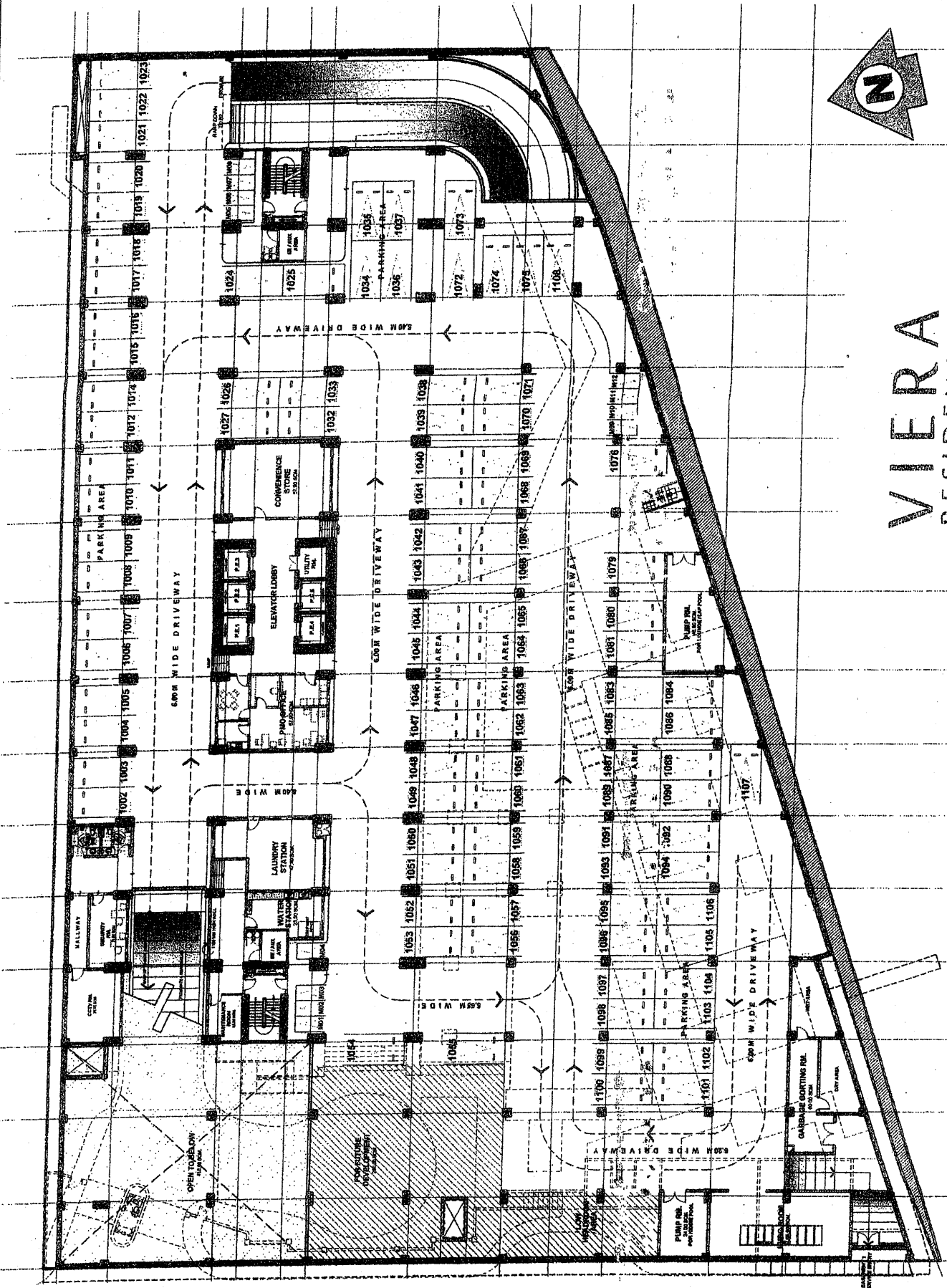

# VIERA RESIDENCES

## BASEMENT PARKING 1 FLOOR PLAN SEPTEMBER 2014

Memo Ref. # DESIGN-14-09-015



NO.	DATE	REVISIONS
1	09/11/14	ISSUED
2	09/11/14	REVISIONS
3	09/11/14	REVISIONS
4	09/11/14	REVISIONS
5	09/11/14	REVISIONS

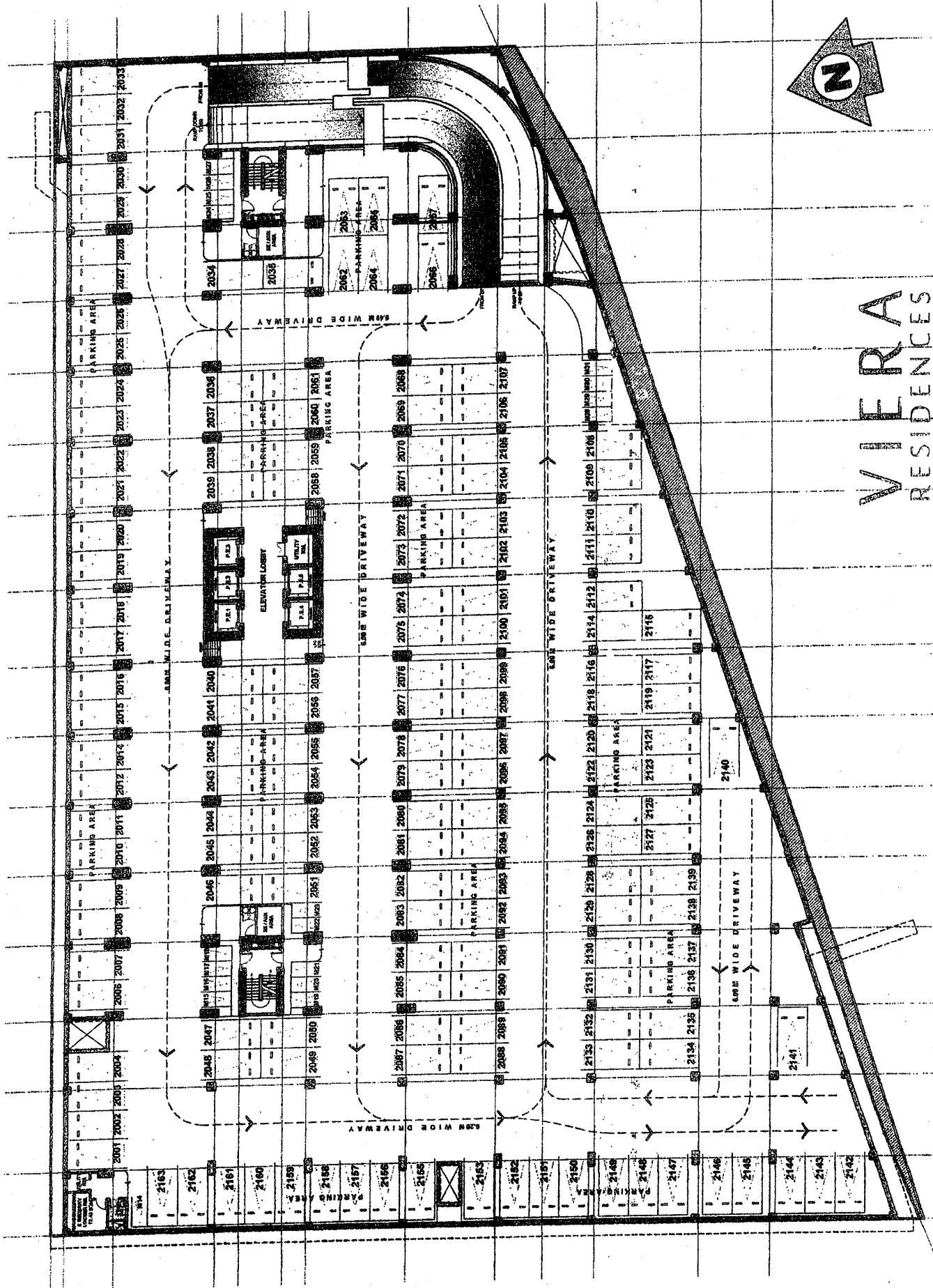
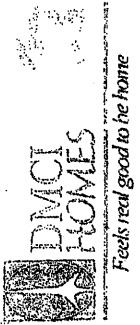

# VIERA RESIDENCES

## BASEMENT PARKING 2 FLOOR PLAN SEPTEMBER 2014

Memo Ref. # DESIGN-14-09-015

NO.	DATE	REVISIONS	BY	CHKD.
1	10/11/14	ISSUE FOR CONSTRUCTION	RMAS	DMCI
2	10/11/14	ISSUE FOR CONSTRUCTION	RMAS	DMCI
3	10/11/14	ISSUE FOR CONSTRUCTION	RMAS	DMCI
4	10/11/14	ISSUE FOR CONSTRUCTION	RMAS	DMCI

NO.	DATE	REVISIONS	BY	CHKD.
1	10/11/14	ISSUE FOR CONSTRUCTION	RMAS	DMCI
2	10/11/14	ISSUE FOR CONSTRUCTION	RMAS	DMCI
3	10/11/14	ISSUE FOR CONSTRUCTION	RMAS	DMCI
4	10/11/14	ISSUE FOR CONSTRUCTION	RMAS	DMCI





# VIERA RESIDENCES

## BASEMENT PARKING 3 FLOOR PLAN

SEPTEMBER 2014

Memo Ref. # DESIGN-14-09-015



NO.	DATE	REVISIONS
1	09/11/14	ISSUE FOR PERMITTING
2	09/11/14	ISSUE FOR PERMITTING
3	09/11/14	ISSUE FOR PERMITTING
4	09/11/14	ISSUE FOR PERMITTING
5	09/11/14	ISSUE FOR PERMITTING
6	09/11/14	ISSUE FOR PERMITTING
7	09/11/14	ISSUE FOR PERMITTING
8	09/11/14	ISSUE FOR PERMITTING
9	09/11/14	ISSUE FOR PERMITTING
10	09/11/14	ISSUE FOR PERMITTING
11	09/11/14	ISSUE FOR PERMITTING
12	09/11/14	ISSUE FOR PERMITTING
13	09/11/14	ISSUE FOR PERMITTING
14	09/11/14	ISSUE FOR PERMITTING
15	09/11/14	ISSUE FOR PERMITTING
16	09/11/14	ISSUE FOR PERMITTING
17	09/11/14	ISSUE FOR PERMITTING
18	09/11/14	ISSUE FOR PERMITTING
19	09/11/14	ISSUE FOR PERMITTING
20	09/11/14	ISSUE FOR PERMITTING
21	09/11/14	ISSUE FOR PERMITTING
22	09/11/14	ISSUE FOR PERMITTING
23	09/11/14	ISSUE FOR PERMITTING
24	09/11/14	ISSUE FOR PERMITTING
25	09/11/14	ISSUE FOR PERMITTING
26	09/11/14	ISSUE FOR PERMITTING
27	09/11/14	ISSUE FOR PERMITTING
28	09/11/14	ISSUE FOR PERMITTING
29	09/11/14	ISSUE FOR PERMITTING
30	09/11/14	ISSUE FOR PERMITTING
31	09/11/14	ISSUE FOR PERMITTING
32	09/11/14	ISSUE FOR PERMITTING
33	09/11/14	ISSUE FOR PERMITTING
34	09/11/14	ISSUE FOR PERMITTING
35	09/11/14	ISSUE FOR PERMITTING
36	09/11/14	ISSUE FOR PERMITTING
37	09/11/14	ISSUE FOR PERMITTING
38	09/11/14	ISSUE FOR PERMITTING
39	09/11/14	ISSUE FOR PERMITTING
40	09/11/14	ISSUE FOR PERMITTING
41	09/11/14	ISSUE FOR PERMITTING
42	09/11/14	ISSUE FOR PERMITTING
43	09/11/14	ISSUE FOR PERMITTING
44	09/11/14	ISSUE FOR PERMITTING
45	09/11/14	ISSUE FOR PERMITTING
46	09/11/14	ISSUE FOR PERMITTING
47	09/11/14	ISSUE FOR PERMITTING
48	09/11/14	ISSUE FOR PERMITTING
49	09/11/14	ISSUE FOR PERMITTING
50	09/11/14	ISSUE FOR PERMITTING
51	09/11/14	ISSUE FOR PERMITTING
52	09/11/14	ISSUE FOR PERMITTING
53	09/11/14	ISSUE FOR PERMITTING
54	09/11/14	ISSUE FOR PERMITTING
55	09/11/14	ISSUE FOR PERMITTING
56	09/11/14	ISSUE FOR PERMITTING
57	09/11/14	ISSUE FOR PERMITTING
58	09/11/14	ISSUE FOR PERMITTING
59	09/11/14	ISSUE FOR PERMITTING
60	09/11/14	ISSUE FOR PERMITTING
61	09/11/14	ISSUE FOR PERMITTING
62	09/11/14	ISSUE FOR PERMITTING
63	09/11/14	ISSUE FOR PERMITTING
64	09/11/14	ISSUE FOR PERMITTING
65	09/11/14	ISSUE FOR PERMITTING
66	09/11/14	ISSUE FOR PERMITTING
67	09/11/14	ISSUE FOR PERMITTING
68	09/11/14	ISSUE FOR PERMITTING
69	09/11/14	ISSUE FOR PERMITTING
70	09/11/14	ISSUE FOR PERMITTING
71	09/11/14	ISSUE FOR PERMITTING
72	09/11/14	ISSUE FOR PERMITTING
73	09/11/14	ISSUE FOR PERMITTING
74	09/11/14	ISSUE FOR PERMITTING
75	09/11/14	ISSUE FOR PERMITTING
76	09/11/14	ISSUE FOR PERMITTING
77	09/11/14	ISSUE FOR PERMITTING
78	09/11/14	ISSUE FOR PERMITTING
79	09/11/14	ISSUE FOR PERMITTING
80	09/11/14	ISSUE FOR PERMITTING
81	09/11/14	ISSUE FOR PERMITTING
82	09/11/14	ISSUE FOR PERMITTING
83	09/11/14	ISSUE FOR PERMITTING
84	09/11/14	ISSUE FOR PERMITTING
85	09/11/14	ISSUE FOR PERMITTING
86	09/11/14	ISSUE FOR PERMITTING
87	09/11/14	ISSUE FOR PERMITTING
88	09/11/14	ISSUE FOR PERMITTING
89	09/11/14	ISSUE FOR PERMITTING
90	09/11/14	ISSUE FOR PERMITTING
91	09/11/14	ISSUE FOR PERMITTING
92	09/11/14	ISSUE FOR PERMITTING
93	09/11/14	ISSUE FOR PERMITTING
94	09/11/14	ISSUE FOR PERMITTING
95	09/11/14	ISSUE FOR PERMITTING
96	09/11/14	ISSUE FOR PERMITTING
97	09/11/14	ISSUE FOR PERMITTING
98	09/11/14	ISSUE FOR PERMITTING
99	09/11/14	ISSUE FOR PERMITTING
100	09/11/14	ISSUE FOR PERMITTING

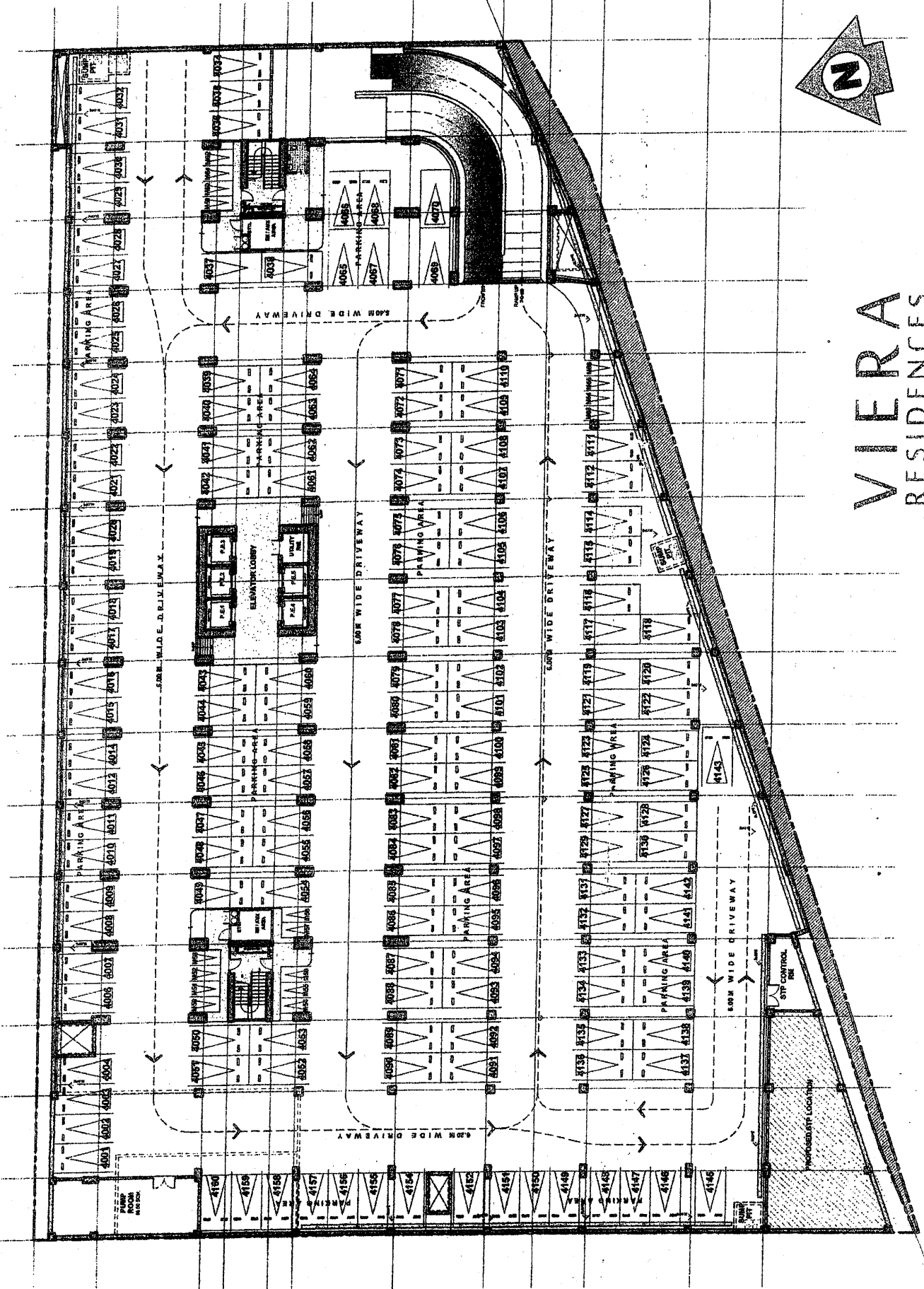

# VIERA RESIDENCES

## BASEMENT PARKING 4 FLOOR PLAN

SEPTEMBER 2014

Memo Ref. # DESIGN-14-09-015

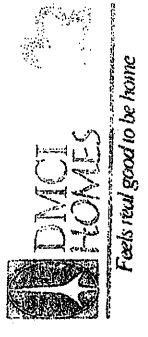

NO.	DATE	REVISIONS
1	APR 07	PRELIMINARY
2	MAY 07	CONVERSION OF UNIT NO. 400 TO 400A
3	JUN 07	BASEMENT PARKING PLAN'S SHEET NUMBER CHANGE TO 400
4	SEP 07	GROUND FLOOR AND MEZZANINE LEVELS (SHEET 20)

NOTED BY: *[Signature]*  
RMS  
GSA

