

Facts need ground to be home

3

NO. OF SLOTS = 87 SLOTS

FACING DRIVEWAY

FACING AMENITIES

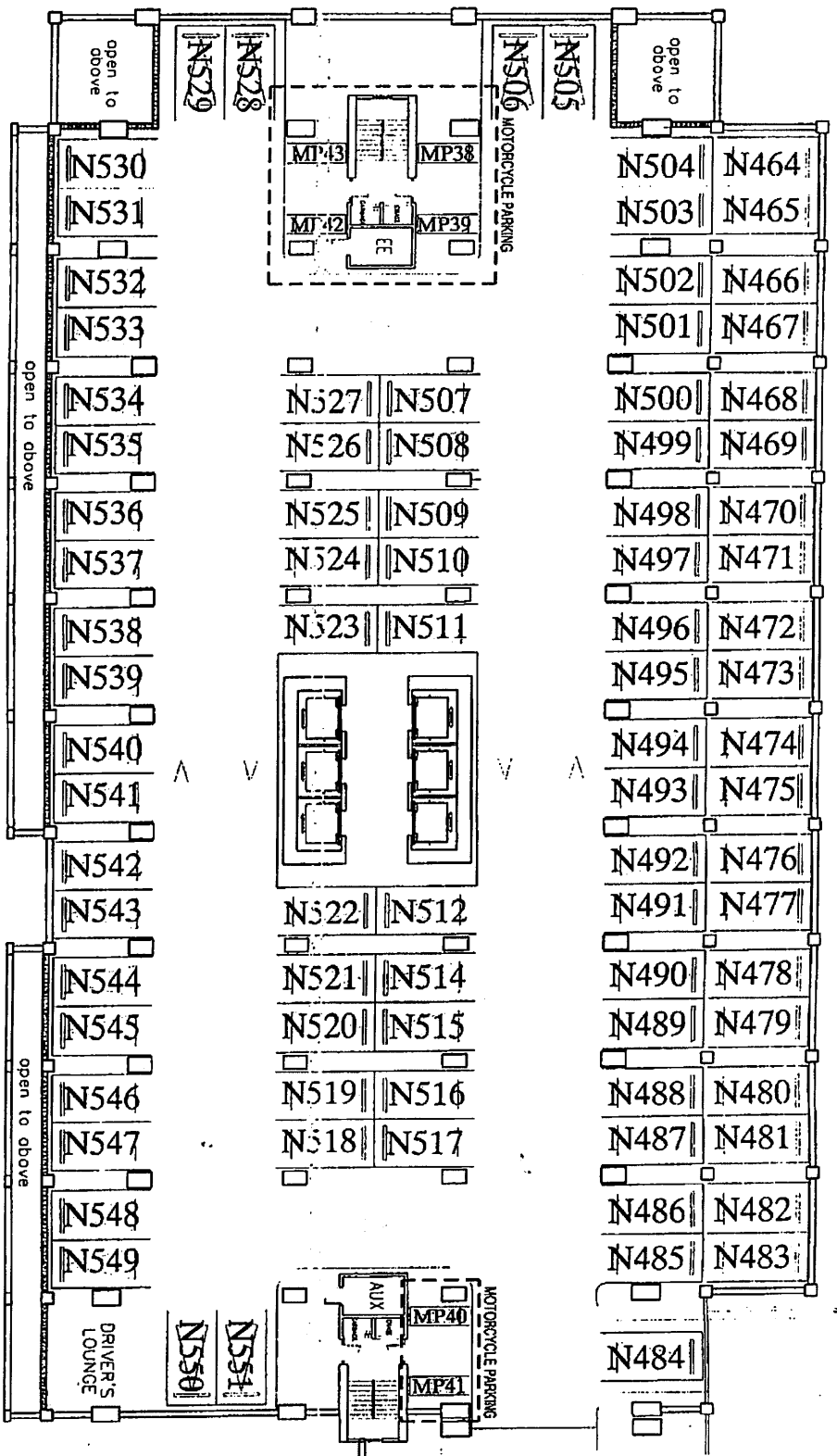

ZINNIA  
TOWERS



NORTH TOWER  
BASEMENT PARKING 3

9 August 2012

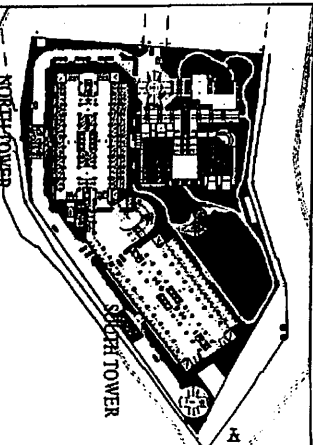

NO.	DATE	REVISIONS
1	10/29/12	ISSUED FOR CONSTRUCTION
2	07/09/12	PARKING AREAS DELETED
3	08/06/12	MOTORCYCLE PARKING ADDED

NOTED BY: RMS  
GSA



DMCI HOMES 33

Featuring Park Avenue

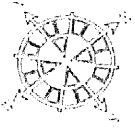

# NORTH TOWER BASEMENT PARKING 2

9 August 2012

## ZINNIA TOWERS

NO. OF SLOTS = 86 SLOTS

FACING DRIVEWAY

FACING AMENITIES

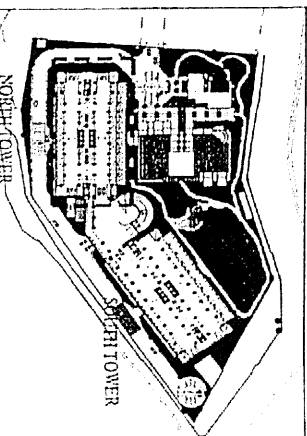
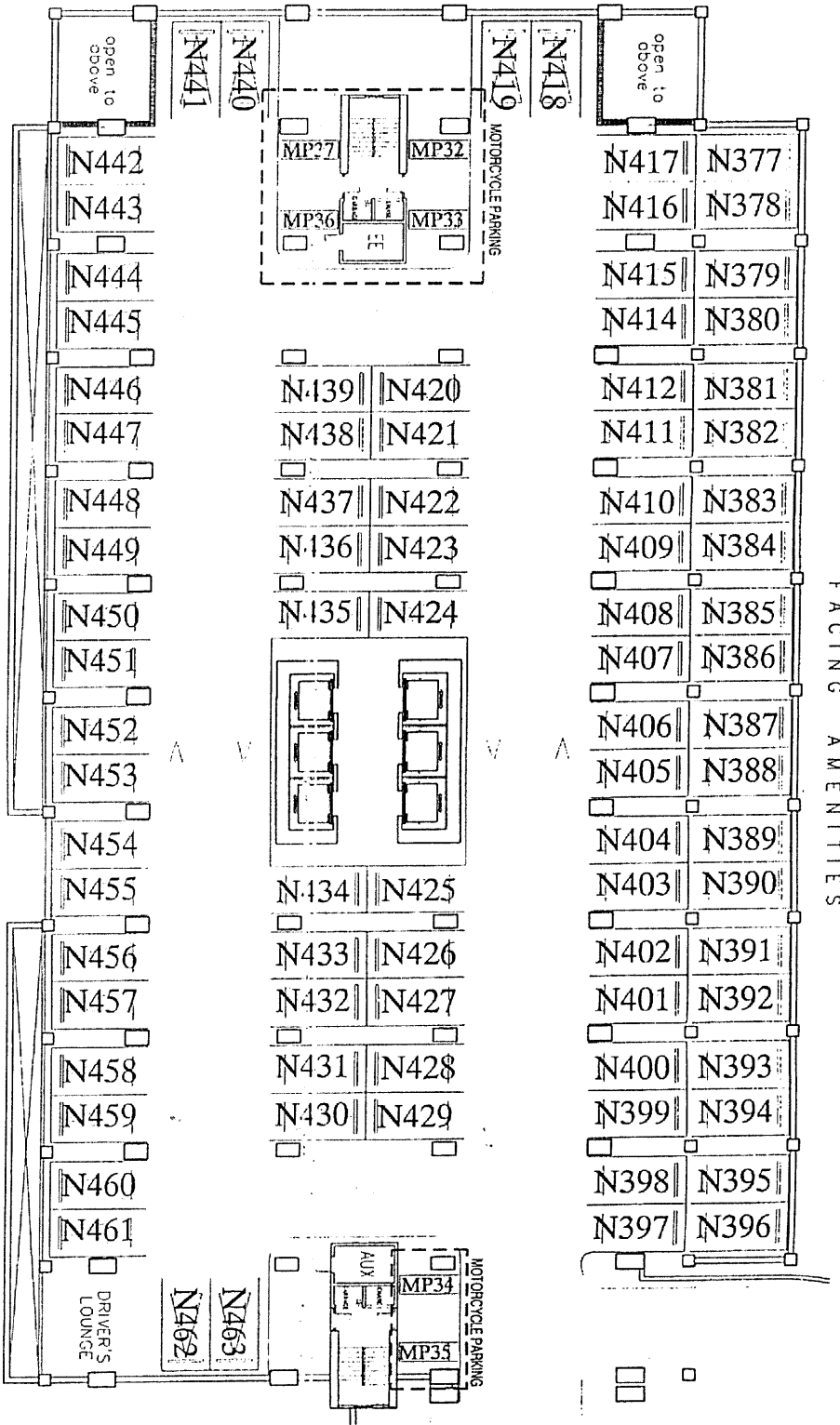

NO.	DATE	REVISIONS
1	07/26/12	ISSUED FOR CONSTRUCTION
2	07/27/12	PARKING AREAS DELETED
3	07/27/12	MOTORCYCLE PARKING ADDED
4	08/09/12	WATERCLOSET ADDED
5	08/09/12	WATERCLOSET ADDED
6	08/09/12	WATERCLOSET ADDED
7	08/09/12	WATERCLOSET ADDED
8	08/09/12	WATERCLOSET ADDED
9	08/09/12	WATERCLOSET ADDED
10	08/09/12	WATERCLOSET ADDED
11	08/09/12	WATERCLOSET ADDED
12	08/09/12	WATERCLOSET ADDED
13	08/09/12	WATERCLOSET ADDED
14	08/09/12	WATERCLOSET ADDED
15	08/09/12	WATERCLOSET ADDED
16	08/09/12	WATERCLOSET ADDED
17	08/09/12	WATERCLOSET ADDED
18	08/09/12	WATERCLOSET ADDED
19	08/09/12	WATERCLOSET ADDED
20	08/09/12	WATERCLOSET ADDED
21	08/09/12	WATERCLOSET ADDED
22	08/09/12	WATERCLOSET ADDED
23	08/09/12	WATERCLOSET ADDED
24	08/09/12	WATERCLOSET ADDED
25	08/09/12	WATERCLOSET ADDED
26	08/09/12	WATERCLOSET ADDED
27	08/09/12	WATERCLOSET ADDED
28	08/09/12	WATERCLOSET ADDED
29	08/09/12	WATERCLOSET ADDED
30	08/09/12	WATERCLOSET ADDED
31	08/09/12	WATERCLOSET ADDED
32	08/09/12	WATERCLOSET ADDED
33	08/09/12	WATERCLOSET ADDED
34	08/09/12	WATERCLOSET ADDED
35	08/09/12	WATERCLOSET ADDED
36	08/09/12	WATERCLOSET ADDED
37	08/09/12	WATERCLOSET ADDED
38	08/09/12	WATERCLOSET ADDED
39	08/09/12	WATERCLOSET ADDED
40	08/09/12	WATERCLOSET ADDED
41	08/09/12	WATERCLOSET ADDED
42	08/09/12	WATERCLOSET ADDED
43	08/09/12	WATERCLOSET ADDED
44	08/09/12	WATERCLOSET ADDED
45	08/09/12	WATERCLOSET ADDED
46	08/09/12	WATERCLOSET ADDED
47	08/09/12	WATERCLOSET ADDED
48	08/09/12	WATERCLOSET ADDED
49	08/09/12	WATERCLOSET ADDED
50	08/09/12	WATERCLOSET ADDED
51	08/09/12	WATERCLOSET ADDED
52	08/09/12	WATERCLOSET ADDED
53	08/09/12	WATERCLOSET ADDED
54	08/09/12	WATERCLOSET ADDED
55	08/09/12	WATERCLOSET ADDED
56	08/09/12	WATERCLOSET ADDED
57	08/09/12	WATERCLOSET ADDED
58	08/09/12	WATERCLOSET ADDED
59	08/09/12	WATERCLOSET ADDED
60	08/09/12	WATERCLOSET ADDED
61	08/09/12	WATERCLOSET ADDED
62	08/09/12	WATERCLOSET ADDED
63	08/09/12	WATERCLOSET ADDED
64	08/09/12	WATERCLOSET ADDED
65	08/09/12	WATERCLOSET ADDED
66	08/09/12	WATERCLOSET ADDED
67	08/09/12	WATERCLOSET ADDED
68	08/09/12	WATERCLOSET ADDED
69	08/09/12	WATERCLOSET ADDED
70	08/09/12	WATERCLOSET ADDED
71	08/09/12	WATERCLOSET ADDED
72	08/09/12	WATERCLOSET ADDED
73	08/09/12	WATERCLOSET ADDED
74	08/09/12	WATERCLOSET ADDED
75	08/09/12	WATERCLOSET ADDED
76	08/09/12	WATERCLOSET ADDED
77	08/09/12	WATERCLOSET ADDED
78	08/09/12	WATERCLOSET ADDED
79	08/09/12	WATERCLOSET ADDED
80	08/09/12	WATERCLOSET ADDED
81	08/09/12	WATERCLOSET ADDED
82	08/09/12	WATERCLOSET ADDED
83	08/09/12	WATERCLOSET ADDED
84	08/09/12	WATERCLOSET ADDED
85	08/09/12	WATERCLOSET ADDED
86	08/09/12	WATERCLOSET ADDED

R/S M/S  
GSA

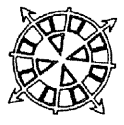

NO. OF SLOTS = 74 SLOTS

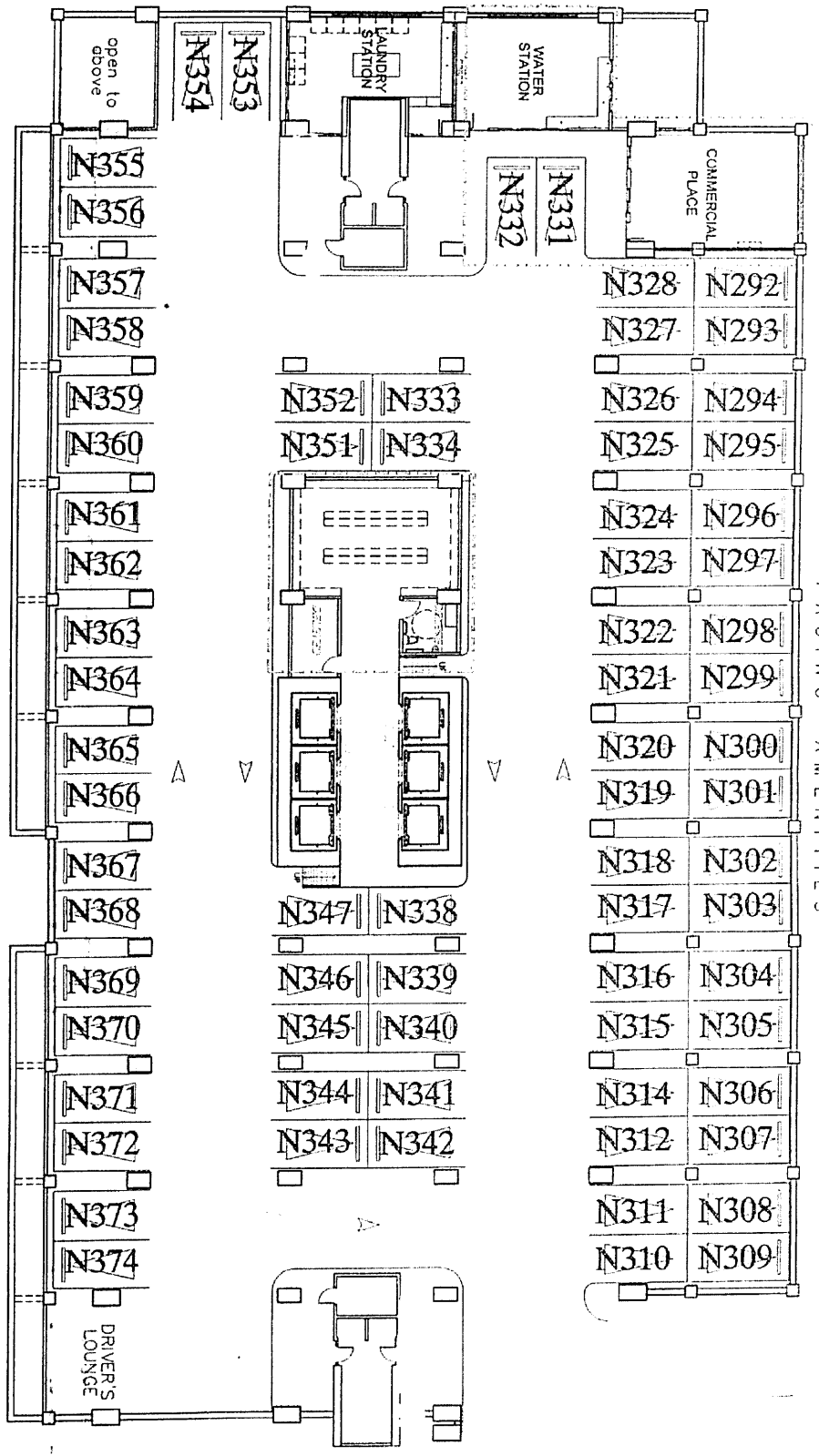

FACING AMENITIES

FACING DRIVEWAY

**ZINNIA TOWERS**  
**NORTH TOWER**  
**BASEMENT PARKING 1**

10 June 2014

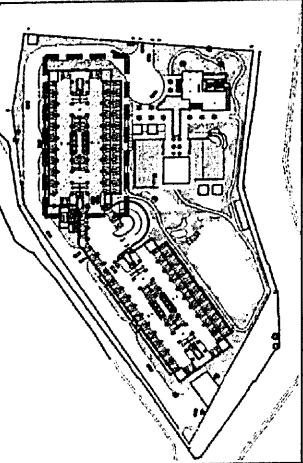

NO.	DATE	REVISIONS
1	03/23/12	ISSUED FOR CONSTRUCTION
2	07/09/12	PARKING AREAS DELETED
3	08/08/12	MOTORCYCLE PARKING ADDED
4	05/07/14	RE-LAYOUT OF GROUND FLOOR AMENITIES

NOTED BY: *[Signature]*  
 GSA

10 JUN 14  
 5/11

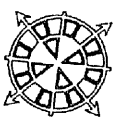
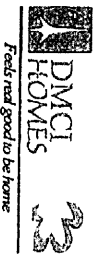

NO. OF SLOTS = 34 SLOTS

FACING DRIVEWAY

FACING AMENITIES

**ZINNIA TOWERS**  
**NORTH TOWER**  
**GROUND FLOOR PLAN**

14 June 2014

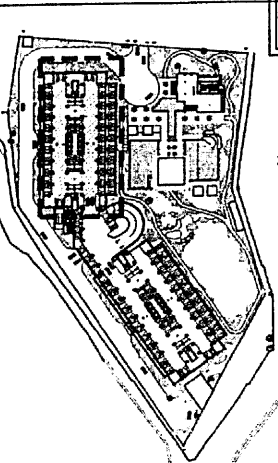
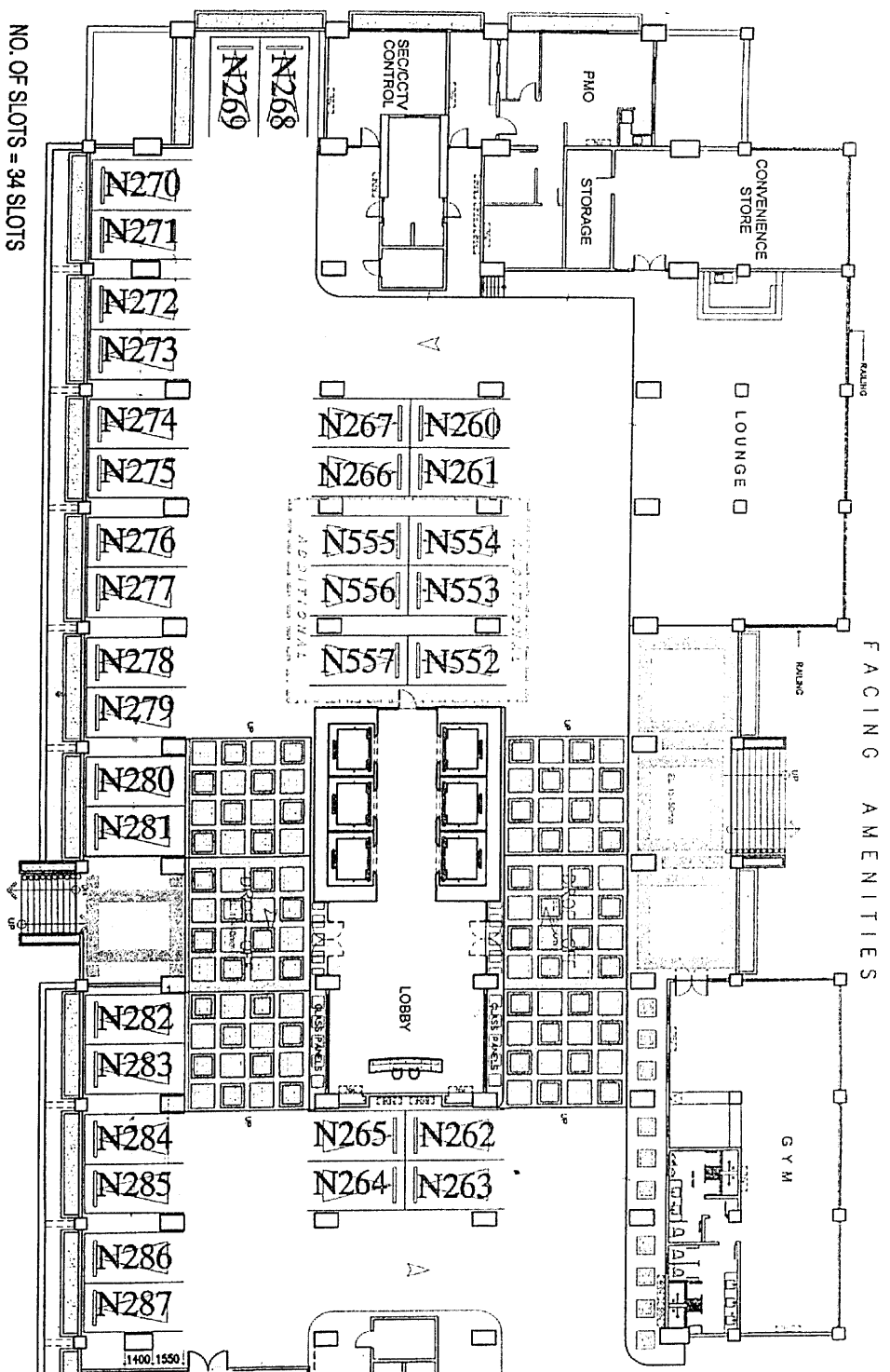

NO.	DATE	REVISIONS	NOTED BY
1	03/29/12	ISSUED FOR CONSTRUCTION	And C.
2	07/04/12	PARKING AREAS DELETED	RMS
3	08/08/12	MOTORCYCLE PARKING ADDED	g
4	06/10/14	RE-LAYOUT OF GROUND FLOOR AMENITIES	g

16 JUN  
 10:27 P

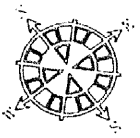

**ZINNIA TOWERS**  
 NORTH TOWER  
 PARKING LEVEL 2  
 9 August 2012

NO. OF SLOTS = 54 SLOTS

FACING DRIVEWAY

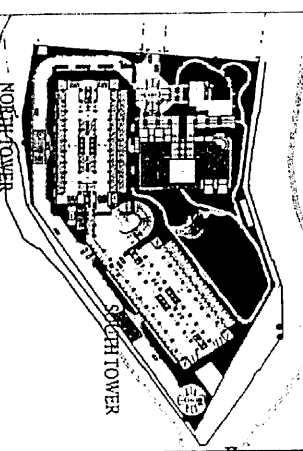
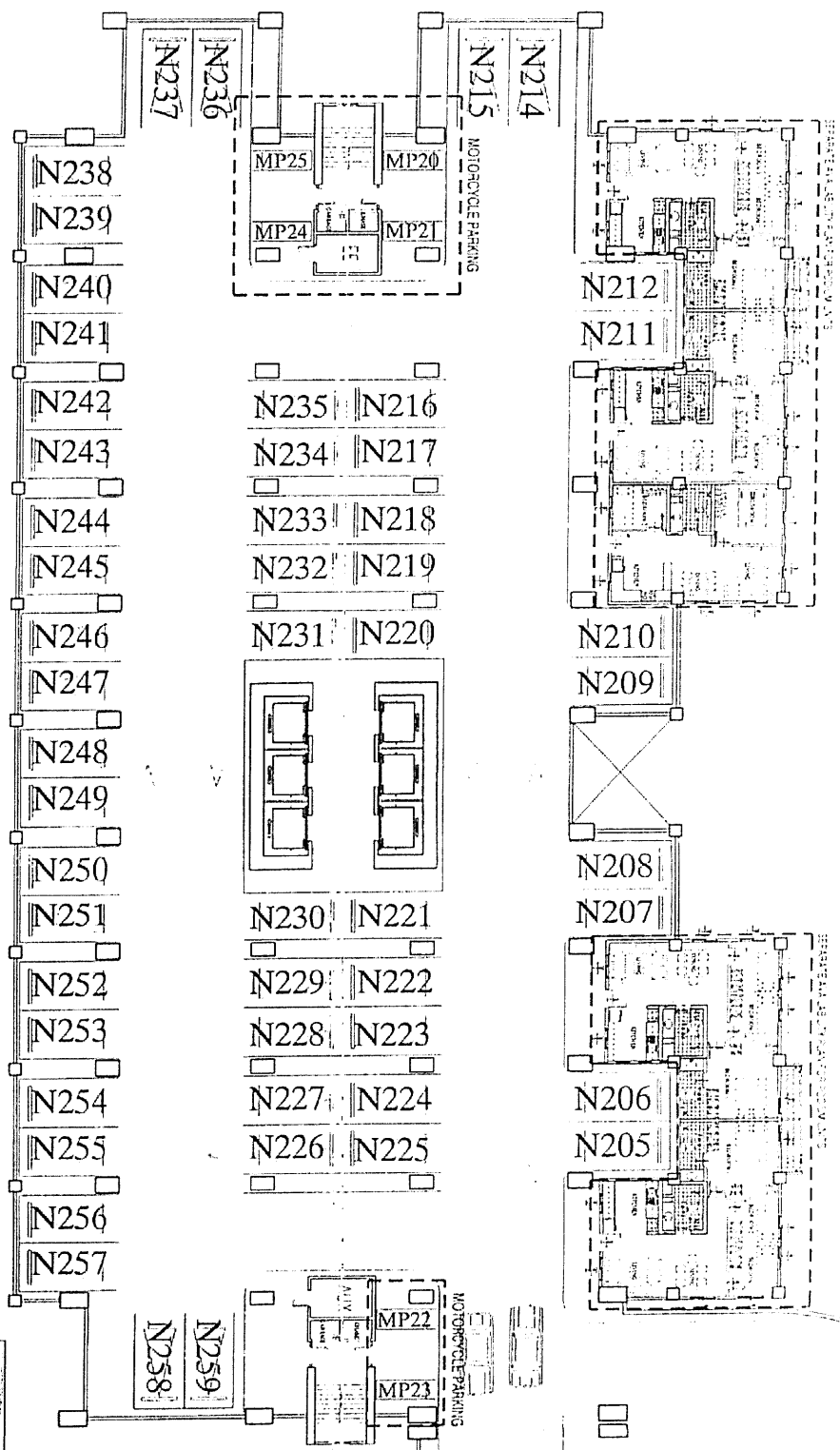

NO.	DATE	REVISIONS
1	03/29/12	ISSUED FOR CONSTRUCTION
2	07/04/12	PARKING AREAS DELETED
3	08/09/12	MOTORCYCLE PARKING ADDED

  

NOTED BY	RMS
GSA	<i>[Signature]</i>



Plans need good to be home

3

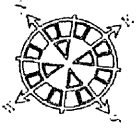

ZINNIA  
TOWERS

NORTH TOWER  
PARKING LEVEL 3

3 August 2012

NO. OF SLOTS = 60 SLOTS

FACING DRIVEWAY

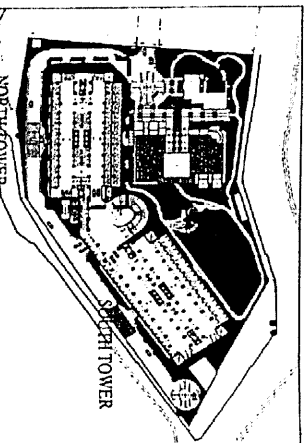
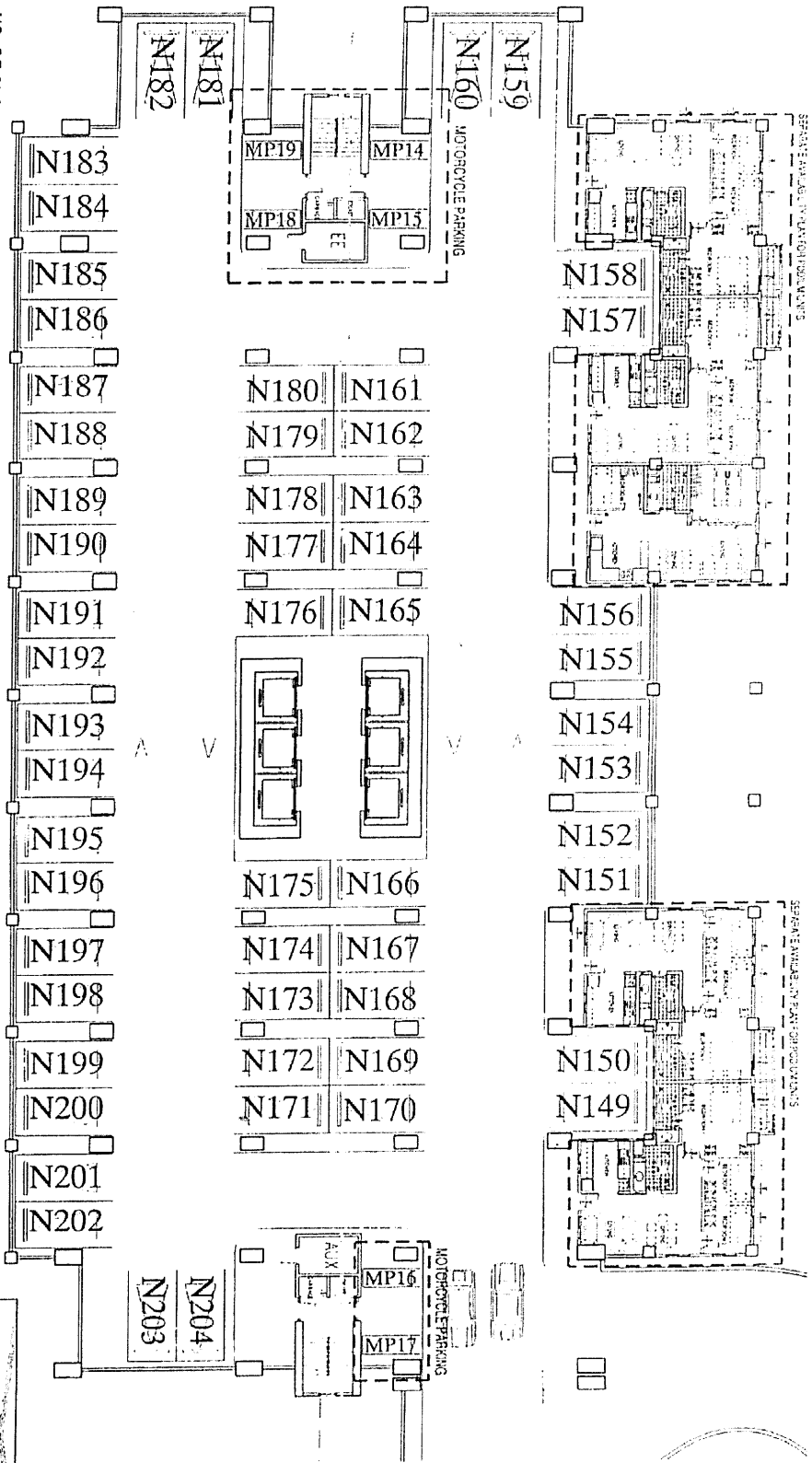

NO. DATE REVISIONS

- 03/29/12 ISSUED FOR CONSTRUCTION
- 07/04/12 PARKING AREAS DELETED
- 08/06/12 MOTORCYCLE PARKING ADDED

NOTED BY  
RMS  
CSA

3

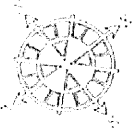

DMCI HOMES

3

Project Address: Unknown

NO. OF SLOTS = 58 SLOTS

FACING DRIVEWAY

FACING AMENITIES

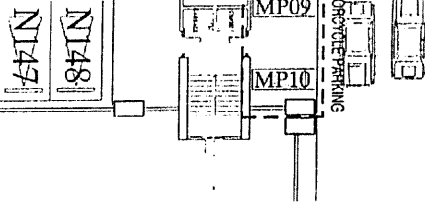
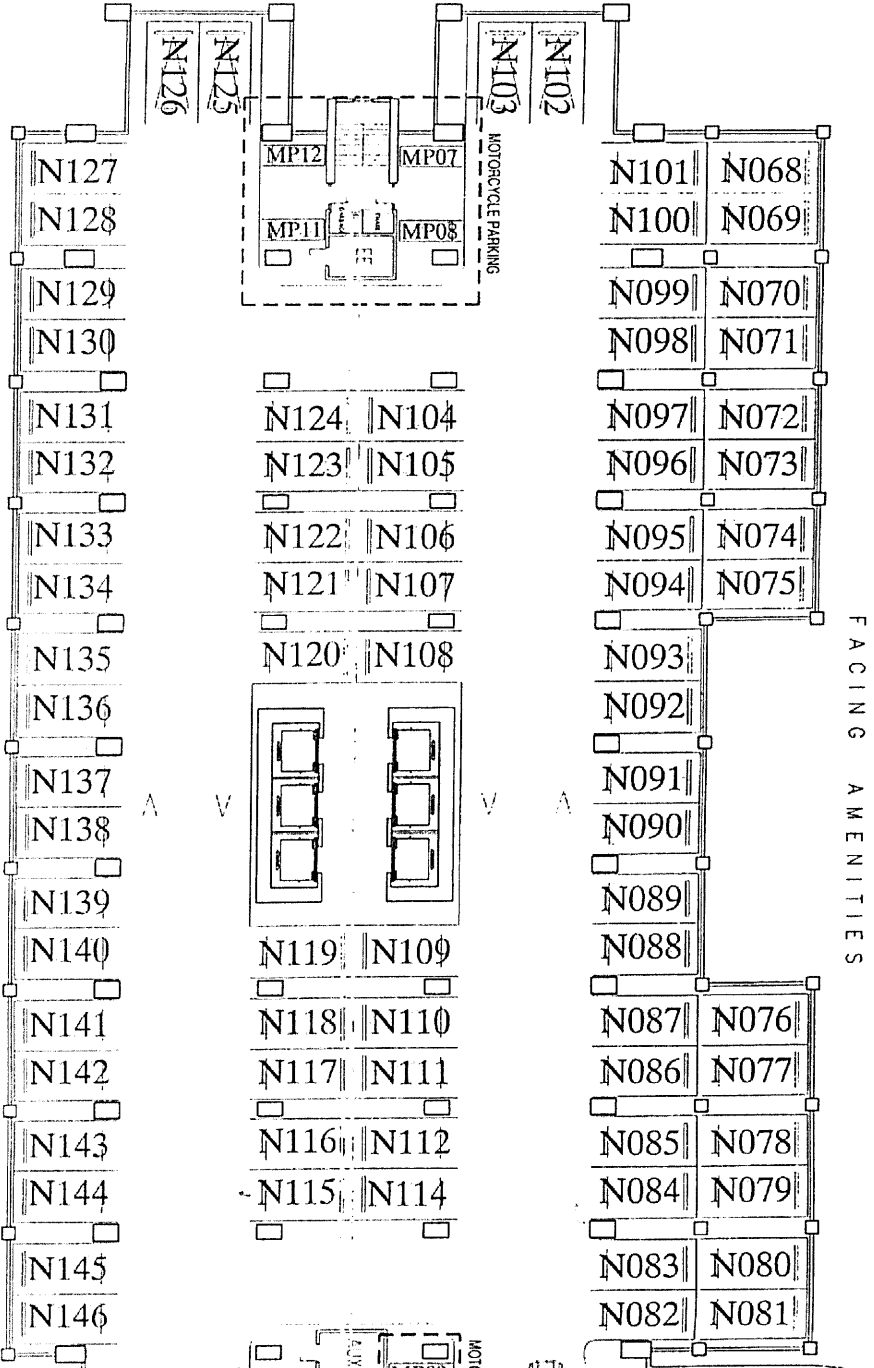

ZINNIA TOWERS

NORTH TOWER  
PARKING LEVEL 4

9 August 2012

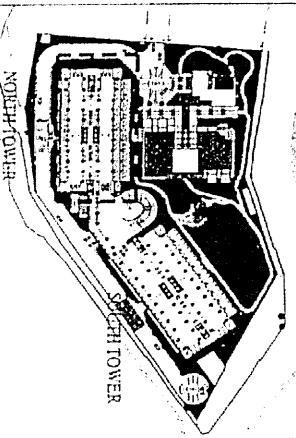

DATE	REVISIONS
11/07/12	ISSUED FOR CONSTRUCTION
11/07/12	REVISED PER COMMENTS RECEIVED
07/25/12	WORKSHEET PARKING PLAN
AB	PLS
CS	PLS
GSA	PLS





FACING AMENITIES

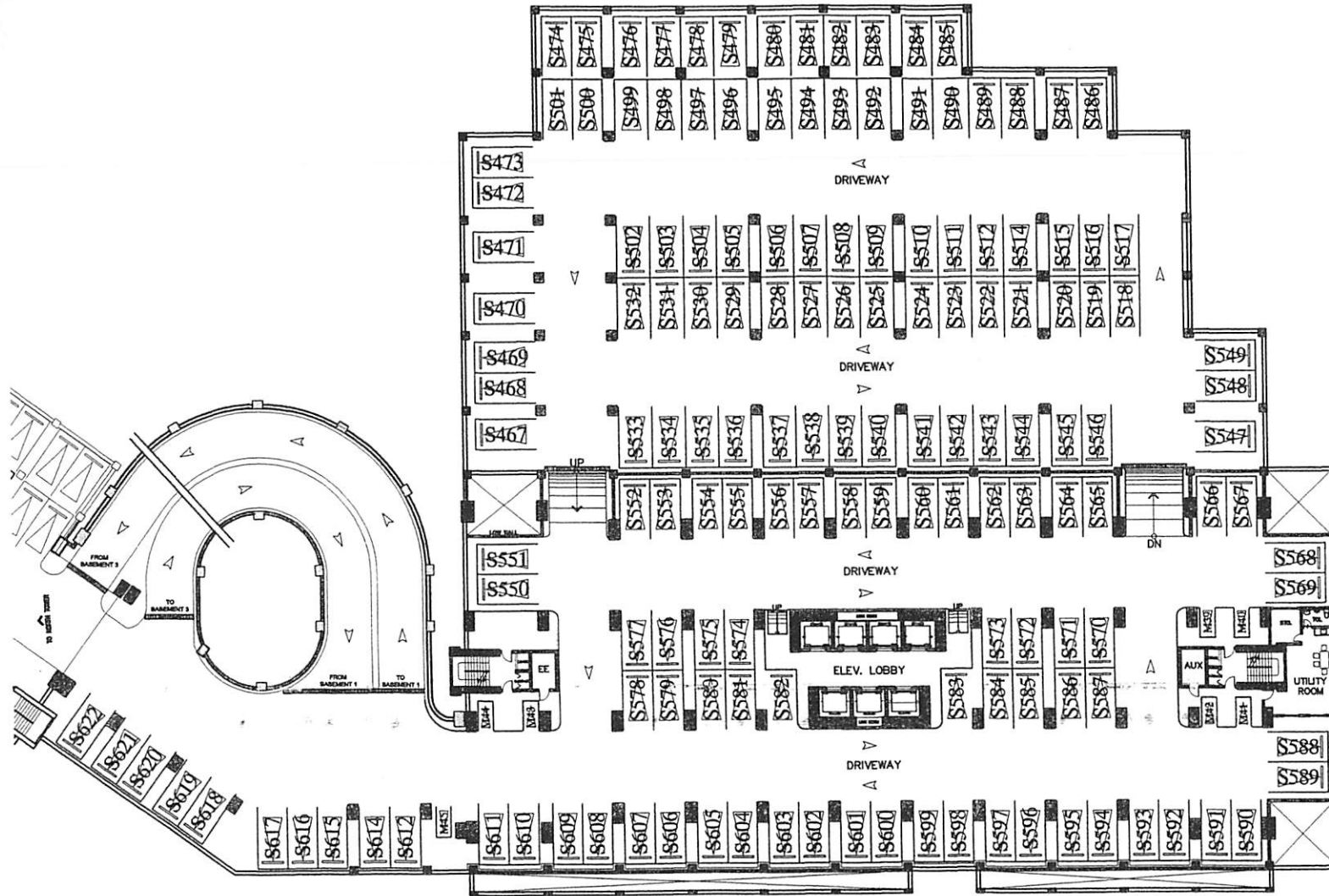

FACING DRIVEWAY



**SOUTH TOWER  
BASEMENT PARKING 2**

01 SEPTEMBER 14

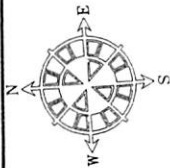

NO. OF SLOTS - 154 SLOTS  
MOTORCYCLE - 7 SLOTS

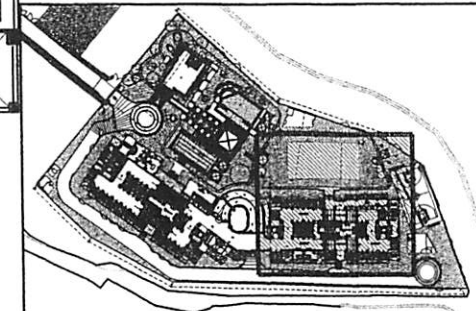

NO.	DATE	REVISIONS	NOTED BY	RMS	GSA

f

FACING AMENITIES

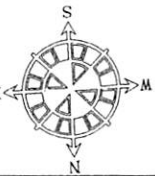
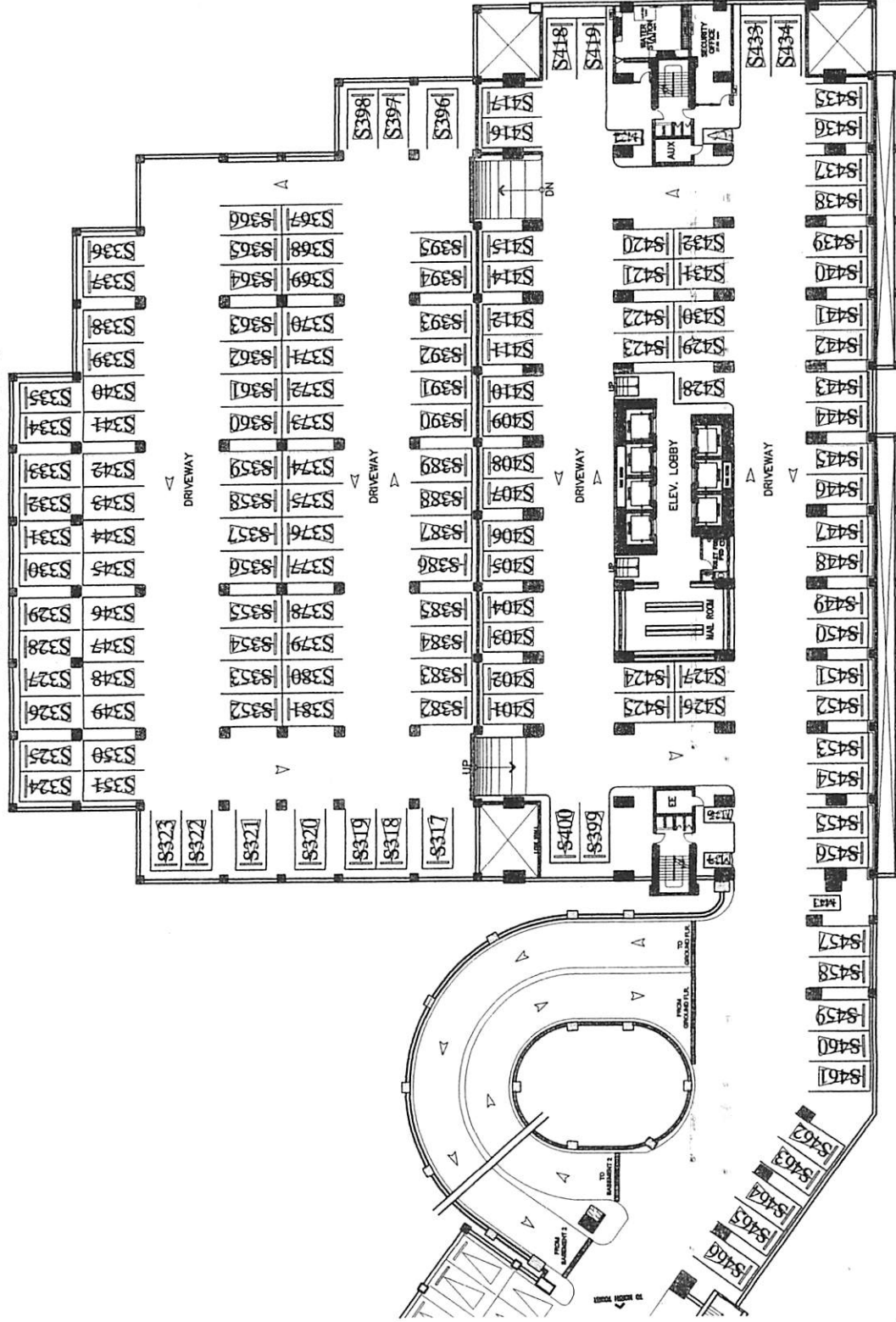

FACING DRIVEWAY

ZINNIA TOWERS

**SOUTH TOWER  
BASEMENT PARKING 1**

01 SEPTEMBER 14

**NO. OF SLOTS - 149 SLOTS  
MOTORCYCLE - 5 SLOTS**

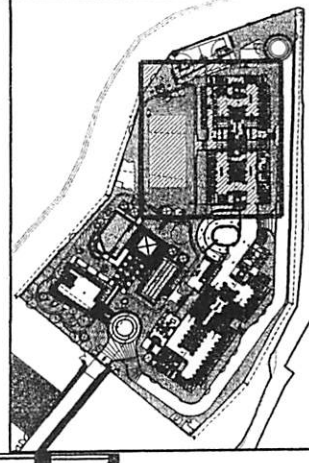

NO. DATE	REVISIONS	NOTED BY	RMS	GSA

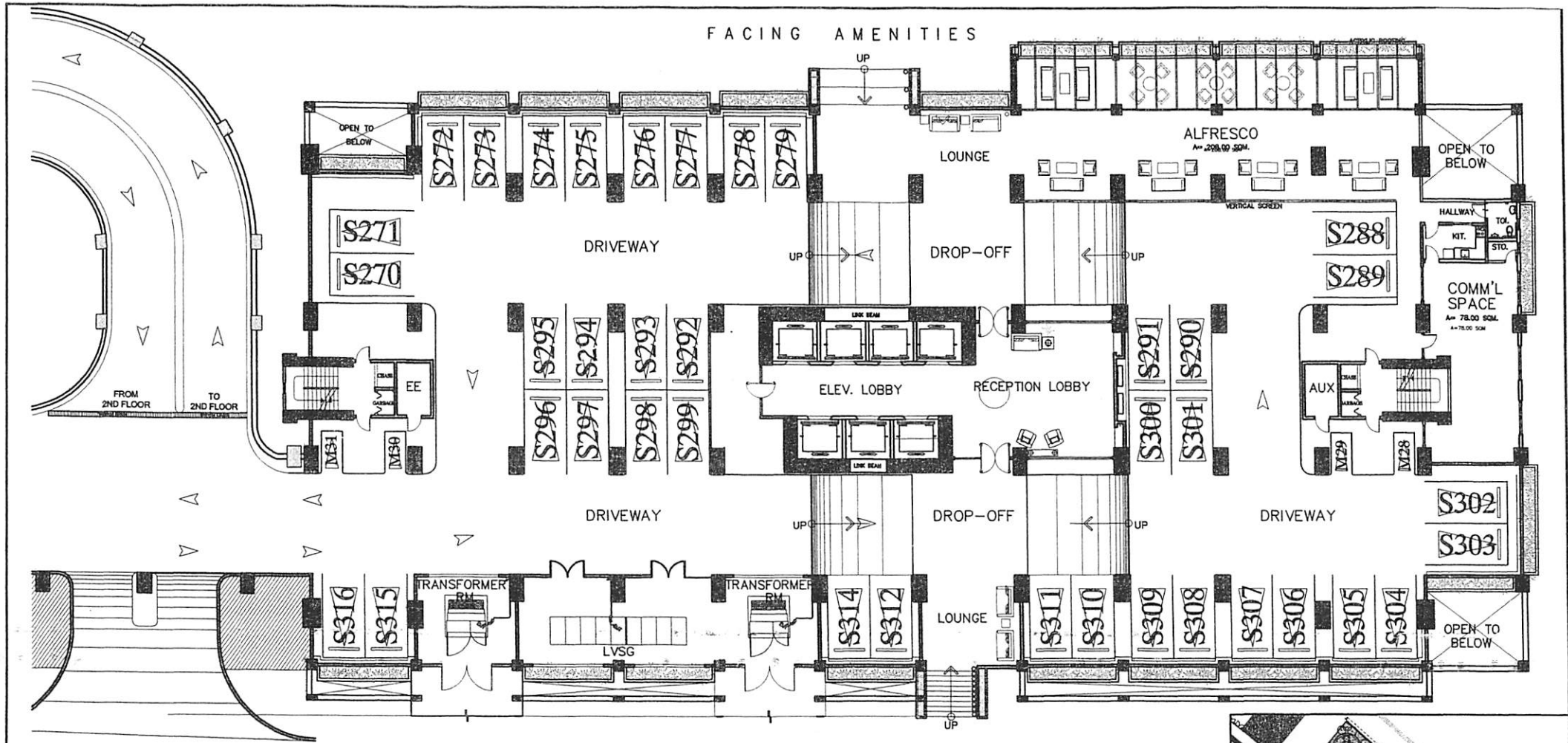

FACING AMENITIES

FACING DRIVEWAY

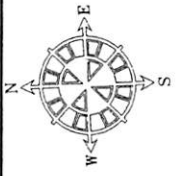

NO. OF SLOTS - 38 SLOTS  
MOTORCYCLE - 4 SLOTS

ZINNIA  
TOWERS  
**SOUTH TOWER**  
**GROUND FLOOR PLAN**  
01 SEPTEMBER 14

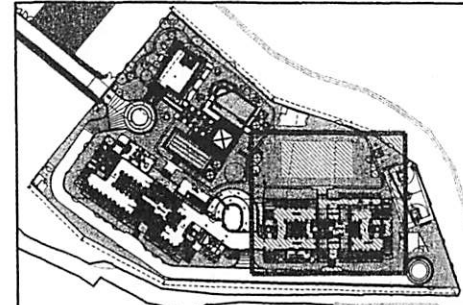

NO.	DATE	REVISIONS

NOTED BY	RMS	<i>[Signature]</i>
	GSA	<i>[Signature]</i>

FACING AMENITIES

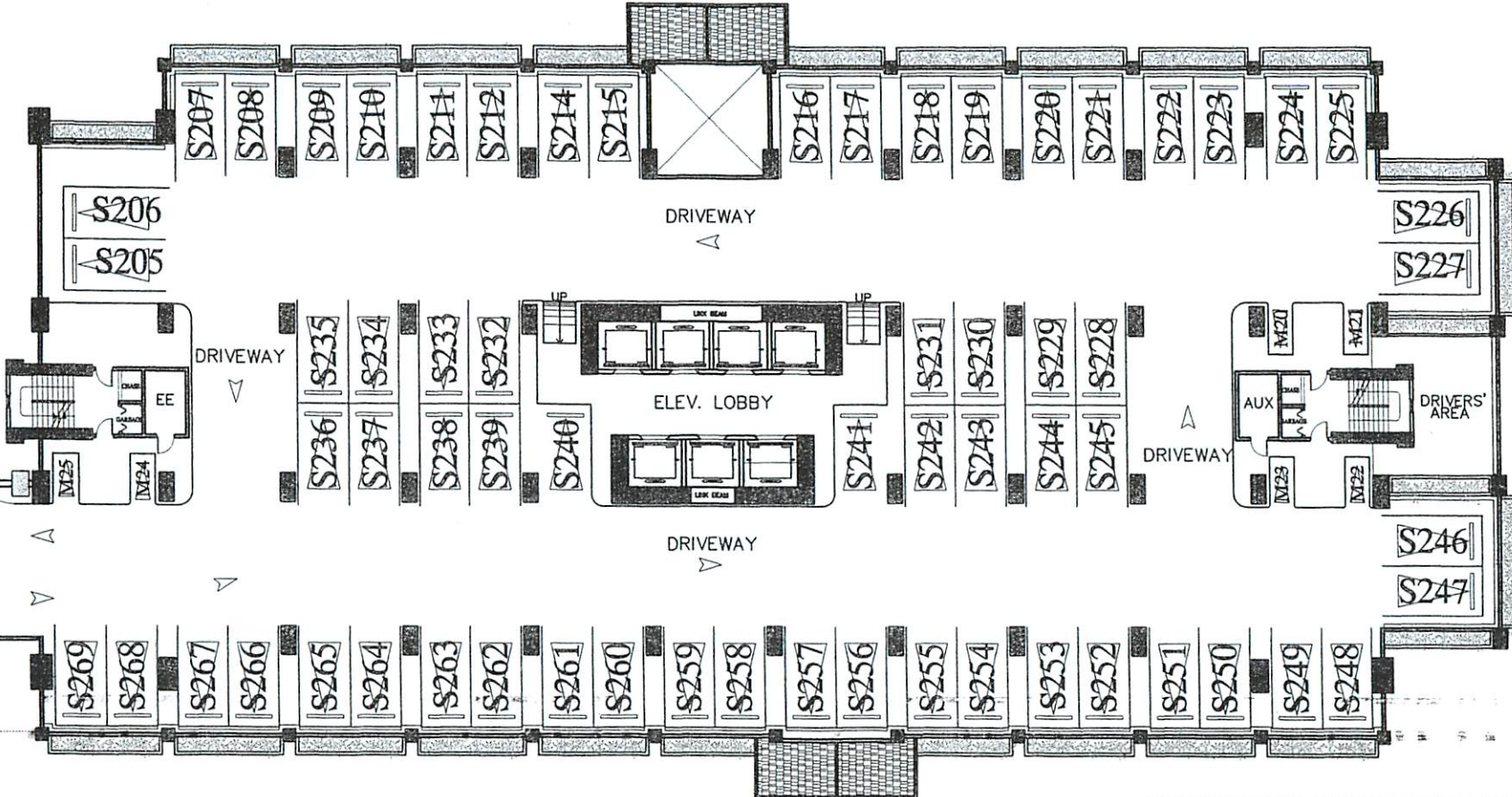
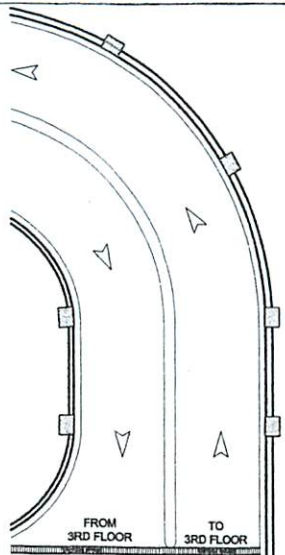

FROM 3RD FLOOR TO 3RD FLOOR

DRIVEWAY

DRIVEWAY

DRIVEWAY

ELEV. LOBBY

DRIVERS' AREA

FACING DRIVEWAY

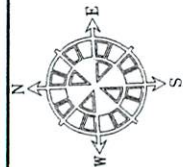

NO. OF SLOTS - 64 SLOTS  
MOTORCYCLE - 6 SLOTS



SOUTH TOWER  
PARKING LEVEL 2

01 SEPTEMBER 14

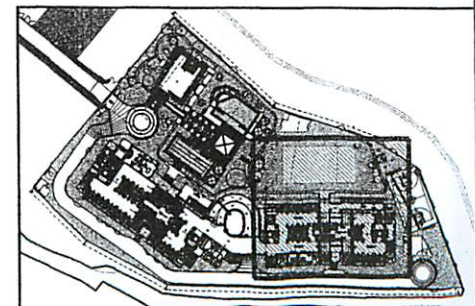

NO.	DATE	REVISIONS

NOTED BY	RMS	<i>[Signature]</i>
	GSA	<i>[Signature]</i>





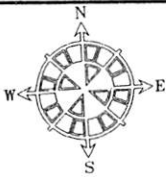

NO. OF SLOTS - 70 SLOTS  
MOTORCYCLE - 6 SLOTS

**SOUTH TOWER**  
PARKING LEVEL 5

01 SEPTEMBER 14

ZINNIA  
TOWERS

FACING DRIVEWAY

FACING AMENITIES

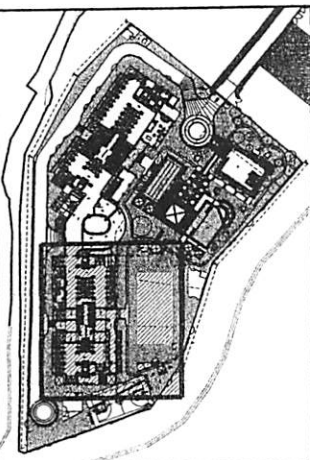
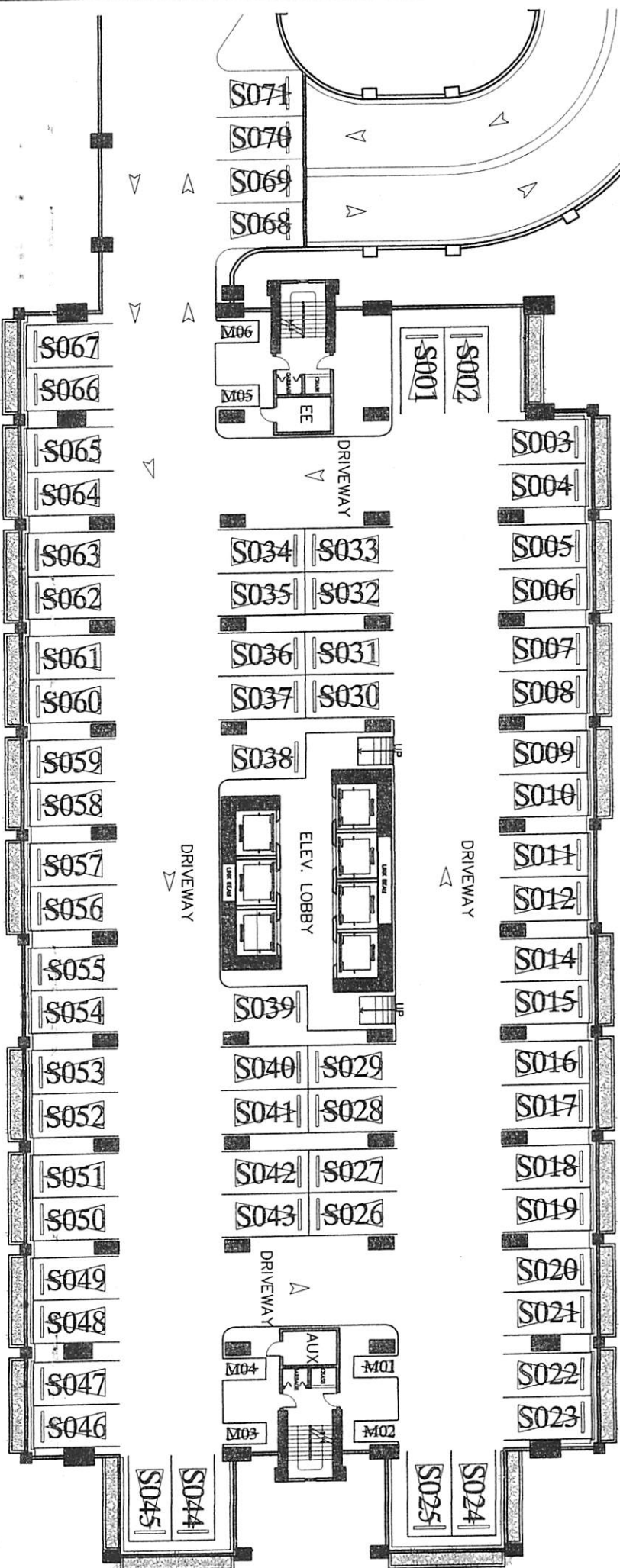

NO.	DATE	REVISIONS

NOTED BY	RMS
GSA	<i>[Signature]</i>